

# MODERN OFFICE

*An innovative campus to fuel creativity  
and connect community*

## PRIMARY SPACES

- 260 Workstations
- 8 Private Offices

## ACTIVITY SPACES

### COLLABORATION

- 1 Breakroom
- 3 Touch Down Areas

### COMMUNICATION

- 12 Meeting Rooms
- 14 Conference Rooms

### CONCENTRATION

- 10 Huddle Rooms

### PRIVACY

- 5 Phone Rooms

## 684 W MAUDE | PHASE 1 | TYPICAL OFFICE

Hypothetical Floor Plan, Floors 2-4

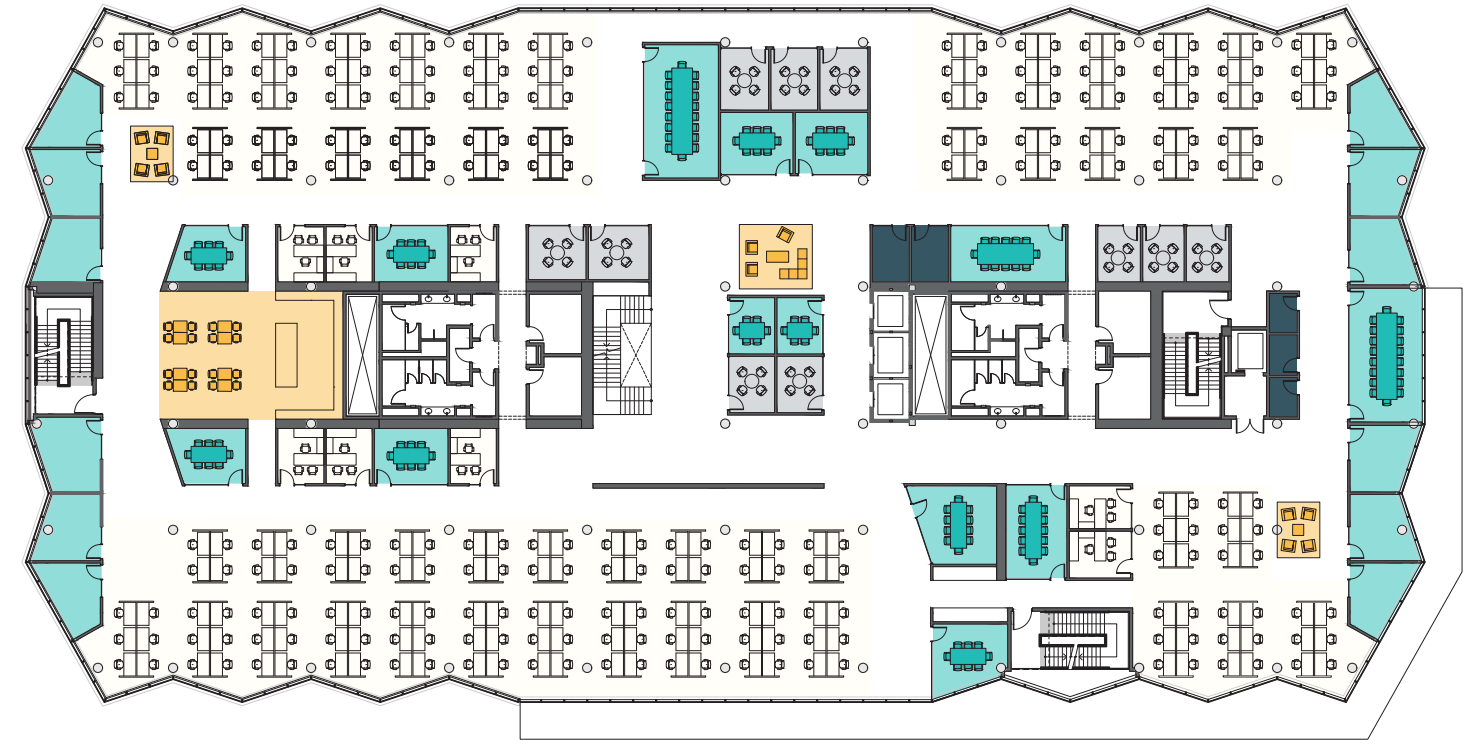

Approximate Headcount | 268 per floor

Phase 1 Ratio | 1:183 SF per floor

Phase 2 Ratio | 1:172 SF per floor

**~45,000 SF/FLOOR**

4 FLOORS | TOTAL ± 195,000 SF